



APEX

FORT WASHINGTON

600-602 Office Center Drive
Fort Washington, PA 19034

Over 80,000 SF of
Class A Office Space Available



- Efficient 49,000± SF floor plates
- 9' finished ceiling heights and ribbon glass system maximize natural light
- Courtyard transformed into an urban plaza with walking paths and outdoor seating
- Apex Café completely redesigned with new finishes, furniture and outdoor patio seating
- Apex Conference / Training Center with complete technology package
- Apex Fitness Center - Tenant only, fully equipped with locker rooms and showers
- Apex Hub - brand new, centralized lounge with Wifi and TV's
- Upgraded finishes throughout all common areas: lobbies, restrooms, elevators and breeze ways
- Parking ratio 5.3/1,000 SF, including 35% covered parking
- On-site property management
- Dual-feed power with automatic transfer switch
- Easy access to the PA Turnpike and Route 309
- On-site public transportation with access to SEPTA regional rail.

For leasing information please contact one of our exclusive brokers:

Patrick Nowlan | Managing Director | t 610.755.6965 | patrick.nowlan@nmrk.com

Justin Bell | Senior Managing Director | t 610.755.6979 | justin.bell@nmrk.com

Jeff Mack | Executive Managing Director | t 610.755.6960 | jeff.mack@nmrk.com

apex-fw.com

NEWMARK

1000 Continental Drive, Suite 200, King of Prussia, PA 19406 t 610.265.0600 nmrk.com

Licensed in Pennsylvania as Newmark Real Estate



APEX

FORT WASHINGTON

600-602 Office Center Drive
Fort Washington, PA 19034



Apex Conference & Training Center



Apex Fitness Center



Outdoor Seating



NEWMARK

For leasing information please contact one of our exclusive brokers:

Patrick Nowlan | Managing Director | t 610.755.6965 | patrick.nowlan@nmrk.com

Justin Bell | Senior Managing Director | t 610.755.6979 | justin.bell@nmrk.com

Jeff Mack | Executive Managing Director | t 610.755.6960 | jeff.mack@nmrk.com

apex-fw.com

The information contained herein has been obtained from sources deemed reliable but has not been verified and no guarantee, warranty or representation, either express or implied, is made with respect to such information. Terms of sale or lease and availability are subject to change or withdrawal without notice.

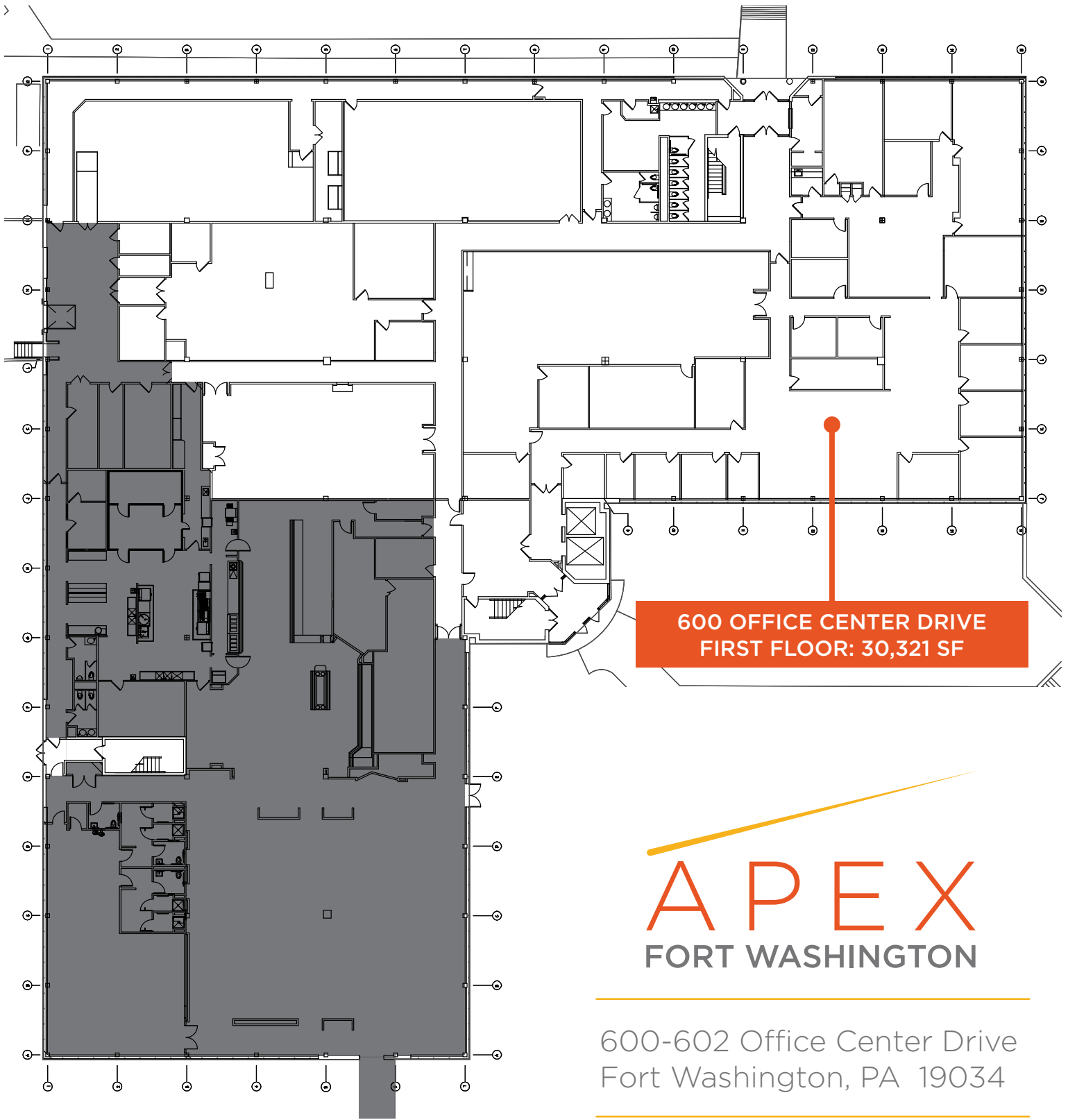

600 OFFICE CENTER DRIVE
FIRST FLOOR: 30,321 SF

APEX

FORT WASHINGTON

600-602 Office Center Drive
Fort Washington, PA 19034

NEWMARK

For leasing information please contact one of our exclusive brokers:

Patrick Nowlan | Managing Director | t 610.755.6965 | patrick.nowlan@nmrk.com

Justin Bell | Senior Managing Director | t 610.755.6979 | justin.bell@nmrk.com

Jeff Mack | Executive Managing Director | t 610.755.6960 | jeff.mack@nmrk.com

apex-fw.com

The information contained herein has been obtained from sources deemed reliable but has not been verified and no guarantee, warranty or representation, either express or implied, is made with respect to such information. Terms of sale or lease and availability are subject to change or withdrawal without notice.



600 OFFICE CENTER DRIVE
SECOND FLOOR: 46,666 SF

APEX
FORT WASHINGTON

600-602 Office Center Drive
Fort Washington, PA 19034

NEWMARK

For leasing information please contact one of our exclusive brokers:

Patrick Nowlan | Managing Director | t 610.755.6965 | patrick.nowlan@nmrk.com

Justin Bell | Senior Managing Director | t 610.755.6979 | justin.bell@nmrk.com

Jeff Mack | Executive Managing Director | t 610.755.6960 | jeff.mack@nmrk.com

apex-fw.com

The information contained herein has been obtained from sources deemed reliable but has not been verified and no guarantee, warranty or representation, either express or implied, is made with respect to such information. Terms of sale or lease and availability are subject to change or withdrawal without notice.

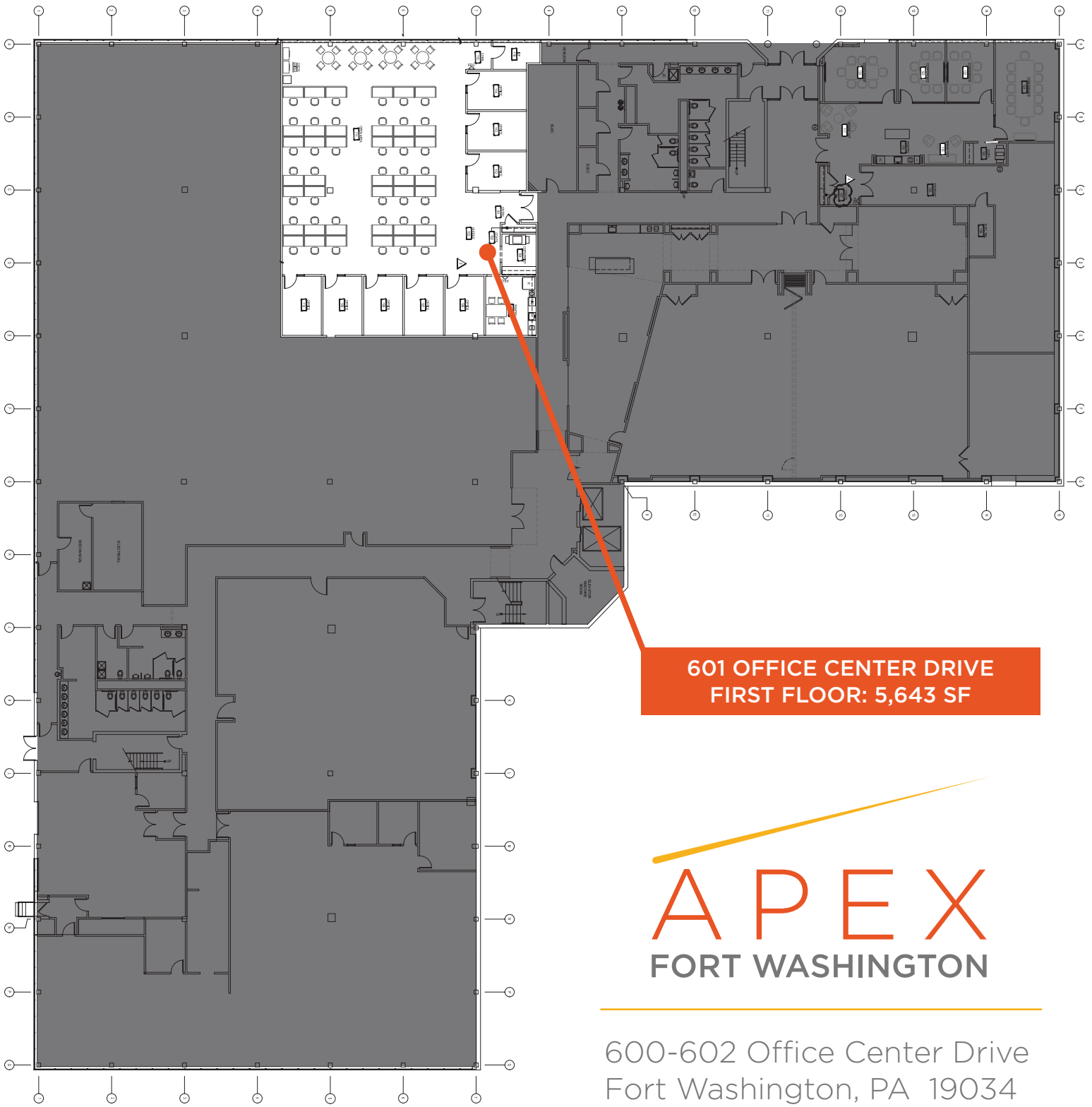

601 OFFICE CENTER DRIVE
FIRST FLOOR: 5,643 SF

APEX
FORT WASHINGTON

600-602 Office Center Drive
Fort Washington, PA 19034

NEWMARK

For leasing information please contact one of our exclusive brokers:

- Patrick Nowlan** | Managing Director | t 610.755.6965 | patrick.nowlan@nmrk.com
- Justin Bell** | Senior Managing Director | t 610.755.6979 | justin.bell@nmrk.com
- Jeff Mack** | Executive Managing Director | t 610.755.6960 | jeff.mack@nmrk.com

apex-fw.com

The information contained herein has been obtained from sources deemed reliable but has not been verified and no guarantee, warranty or representation, either express or implied, is made with respect to such information. Terms of sale or lease and availability are subject to change or withdrawal without notice.

APEX

FORT WASHINGTON

600-602 Office Center Drive
Fort Washington, PA 19034

Now is your opportunity to join our
exciting roster of existing tenants



NEWMARK

For leasing information please contact one of our exclusive brokers:

Patrick Nowlan | Managing Director | t 610.755.6965 | patrick.nowlan@nmrk.com

Justin Bell | Senior Managing Director | t 610.755.6979 | justin.bell@nmrk.com

Jeff Mack | Executive Managing Director | t 610.755.6960 | jeff.mack@nmrk.com

apex-fw.com

The information contained herein has been obtained from sources deemed reliable but has not been verified and no guarantee, warranty or representation, either express or implied, is made with respect to such information. Terms of sale or lease and availability are subject to change or withdrawal without notice.